

EDITION #115 MAY 2025

# *Inside*

LIFESTYLE & INTERIORS

GNAPPEL



# *Inside*

EDITION #115

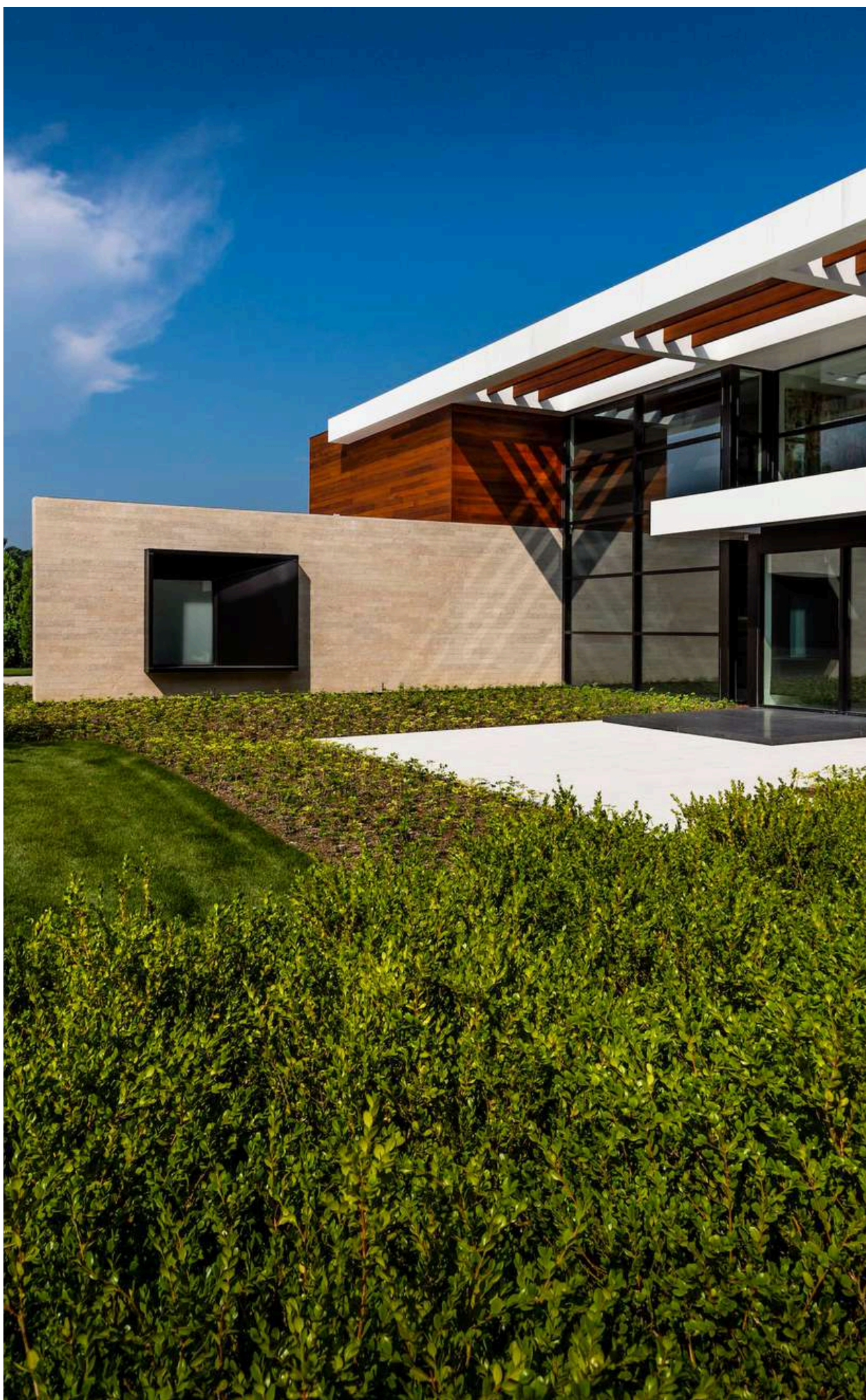

Inside Old Westbury, New York, the Old Westbury Residence by Mojo Stumer Associates is a masterclass in sculpted minimalism. Principal architect Mark Stumer and interior designer Jessica Licalzi crafted a refined, contemporary home defined by architectural clarity, moody textures, and rich material layering—where every surface, sculpture, and shadow is purposefully placed to evoke presence, not excess.



Mark Stumer



# CAFÉ

---

DISTINCT BY DESIGN™

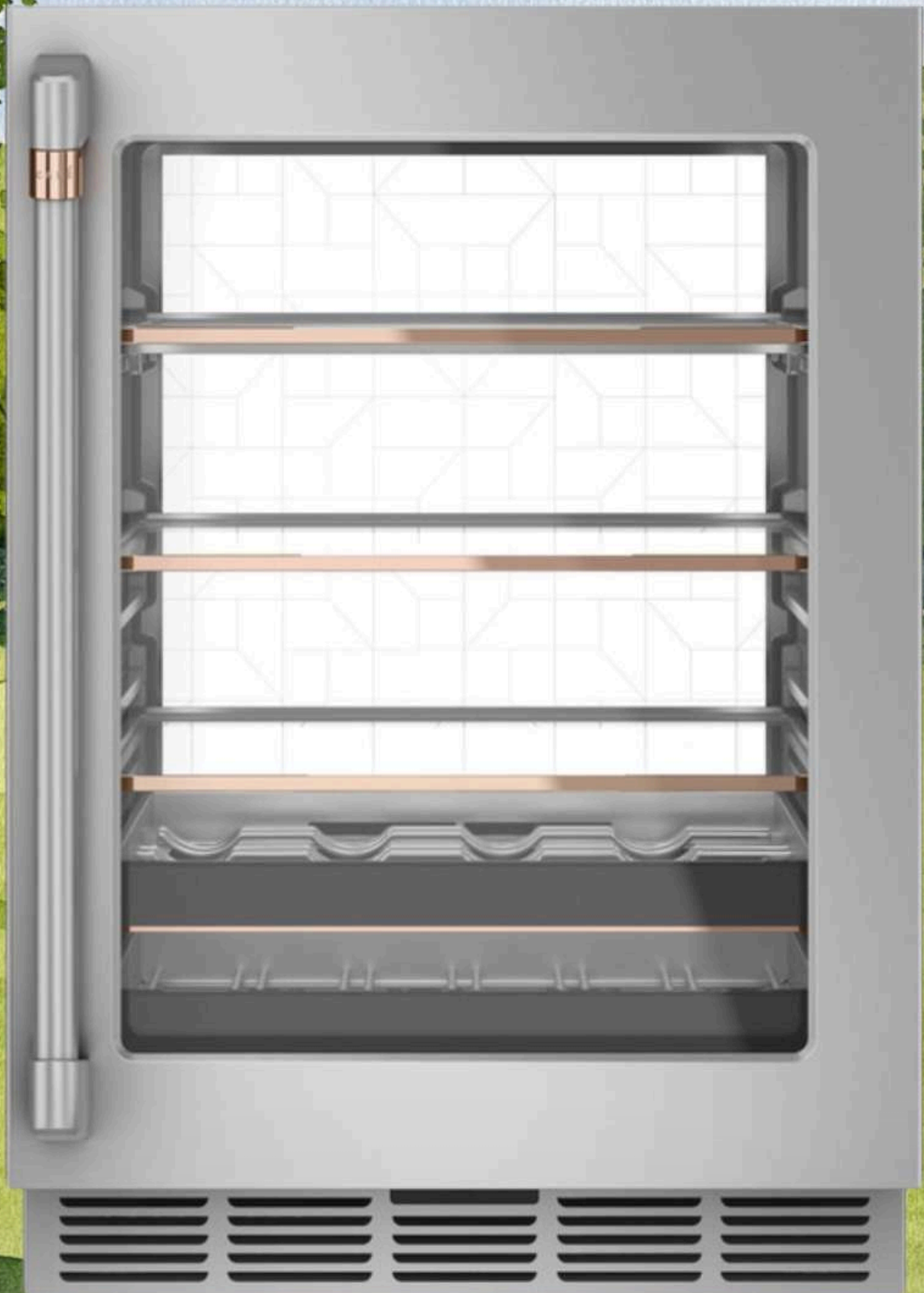

Café™ ENERGY STAR® Beverage Center

[WWW.CAFEAPPLIANCES.COM](http://WWW.CAFEAPPLIANCES.COM)







# CONTEMPORA

A SOFT TAKE ON CONTEMPORARY—FLUID, FRESH, AND EVOLVING.

We often throw around words like modern and contemporary without pausing to ask—what do they really mean? Somewhere along the way, these terms have been boxed into aesthetic clichés, steering us toward a visual formula that may not reflect the essence of what modernity truly is.

The truth is, modernity is fluid. It shifts. It borrows. It evolves. And that's what I found so captivating about the Old Westbury Residence. On the surface, yes, it is contemporary. But when you look deeper—at the sculptural forms, the expressive volume of space, the restrained palette layered with deep, textured woods—you realize it draws confidently from past eras and postmodern moments.

The home doesn't just sit in a moment—it bridges them. The art, the sculptural lighting, the oversized gestures of space—they each whisper of different decades, yet belong completely to now. That's the kind of home I find most inspiring. One that doesn't follow design language—it writes its own.

This issue, we celebrate that freedom: to define spaces on your own terms. To create with feeling. To live with design that speaks not just to trends, but to timelessness.

Lepang













The Old Westbury Residence moodboard orchestrates a sophisticated dialogue between warm naturalism and crisp modernism. Rich mahogany cladding provides organic warmth, juxtaposed against pristine white overhangs and strong black window frames. Interior spaces embrace a restrained palette of whites, soft grays, and subtle earth tones. Material contrasts create visual interest—smooth marble against textural stone, polished concrete beside natural wood grain. Glass dominates, dissolving boundaries between spaces while flooding interiors with natural light. Furnishings maintain clean lines and neutral tones, emphasizing architectural elements rather than competing with them. The overall mood evokes contemplative sophistication—a serene environment where every material transition feels deliberate and refined.

# EIRÉL

BREEZY, CALM, AND EFFORTLESSLY AIRY INTERIOR COMPOSITION.

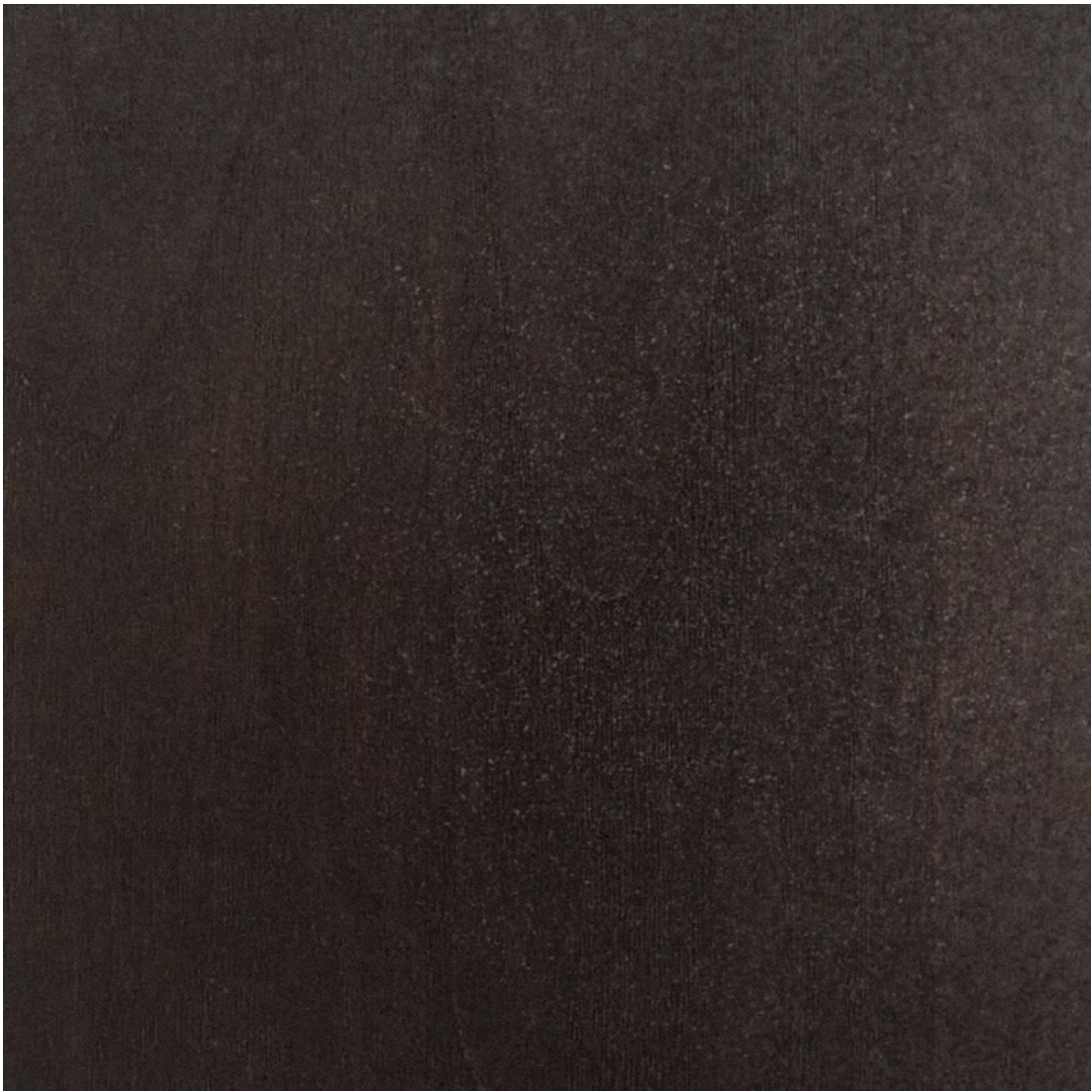

115/  
MOODBOARD





# The Woodley



# COMPOSED *CONTRAST*

Set in the green, tree-filled surroundings of Old Westbury in Long Island, the Old Westbury Residence is a striking example of how modern design can work beautifully with nature. Designed by Mojo Stumer Associates, this home shows what's possible when architecture doesn't just sit on the land, but becomes part of it. Clean lines, bold details, and natural materials come together in a space that feels both luxurious and connected to its environment.

From the outside, the home is a mix of warmth and sharp modern edges. Rich mahogany wood on the façade brings in natural tones that echo the surrounding landscape, while sleek white metal overhangs float lightly above, adding a fresh, contemporary contrast. The black-framed windows add definition and depth without overpowering the structure. It's a home designed with precision and purpose—every element carefully balanced to feel calm, modern, and grounded.

“We wanted to create a real relationship between the house and the landscape,” says principal architect Mark Stumer. The long, horizontal lines of the design help the house feel more relaxed and less imposing, even though it's a two-story structure. One standout feature is a large, steel-framed window that juts out at an angle—breaking the symmetry just enough to catch your attention and hint at the creative design inside.

Stepping into the home, the connection to the outdoors becomes even stronger. Floor-to-ceiling glass along the back of the house opens up the interior to sweeping views of the manicured gardens, designed by Stuart Senter Inc. and Laguardia Design Group. Stone walls stretch from outside to inside, further blending the boundaries and creating a flow that feels effortless. This indoor-outdoor feel isn't just an idea—it's part of how the house lives and breathes.

The interiors, led by designer Jessica Licalzi, are quietly luxurious. Soft whites, touches of grey, black metal, and glass make up the main palette—elegant and understated so that the architecture and views take the spotlight. Rooms are laid out in a long, open plan, running parallel to the glass rear wall. The kitchen, wrapped in white marble, is a standout moment—both a sculptural centerpiece and a highly functional space. Living and family areas are open yet defined, separated by a sleek double-sided fireplace and a media wall. A full-height, glass wine display acts as a divider while showing off a carefully curated collection, and behind it, a floating staircase adds a sculptural moment to the flow of the house.

The main bedroom suite is designed for comfort and calm, with thoughtful touches that reflect the home's overall mood. There's a private study with a custom S-shaped desk—designed not only to look beautiful but to allow for shared work time without compromise. In the bathroom, warm clay-colored tiles and dark wood panels add a grounded, natural feel, while clear glass, polished steel, and white ceilings bring in a crisp modern edge. A standout feature here is the bathtub, made entirely of glass and set into a floor of river stones, filled by a nearly invisible ceiling faucet. It's a moment of quiet drama—simple, beautiful, and completely unexpected.

The suite opens onto a private terrace, with slatted walls that create privacy while still giving a glimpse of the pool and garden beyond. The infinity lap pool runs alongside the house, perfectly in line with its geometry. Just a few steps away is a detached cabana, designed as a sleek, open space for relaxing or entertaining outdoors. With screens and shaded areas, it's as elegant and carefully considered as the home itself.

The outdoor areas deserve as much attention as the interiors. A grid of concrete pavers, spaced with strips of grass, leads to the front door—a simple yet striking entrance that sets the tone for what's inside. The landscaping doesn't just frame the house; it becomes part of the architecture, working hand in hand with the materials and forms of the building.

What makes the Old Westbury Residence special isn't just how it looks—it's how everything works together. The bold shapes, the natural finishes, the way the house opens to the outdoors, and the mix of rich textures and clean lines all feel perfectly in sync. This is a home that doesn't follow trends. It feels timeless. Confident. Balanced.

Mojo Stumer Associates have taken an existing structure and turned it into a calm, modern sanctuary. The house feels luxurious without trying too hard, and every space has been designed with real thought and purpose. It's a place that shows how modern architecture can be warm, welcoming, and completely at home in nature. More than just a beautiful house, the Old Westbury Residence is a reminder of how great design can truly shape the way we live.





*Inside* | EDITION #115









*Inside* | EDITION #115

















*Inside* | EDITION #115





















*Inside* | EDITION #115





*Inside* | EDITION #115



# THE KITCHEN EDIT

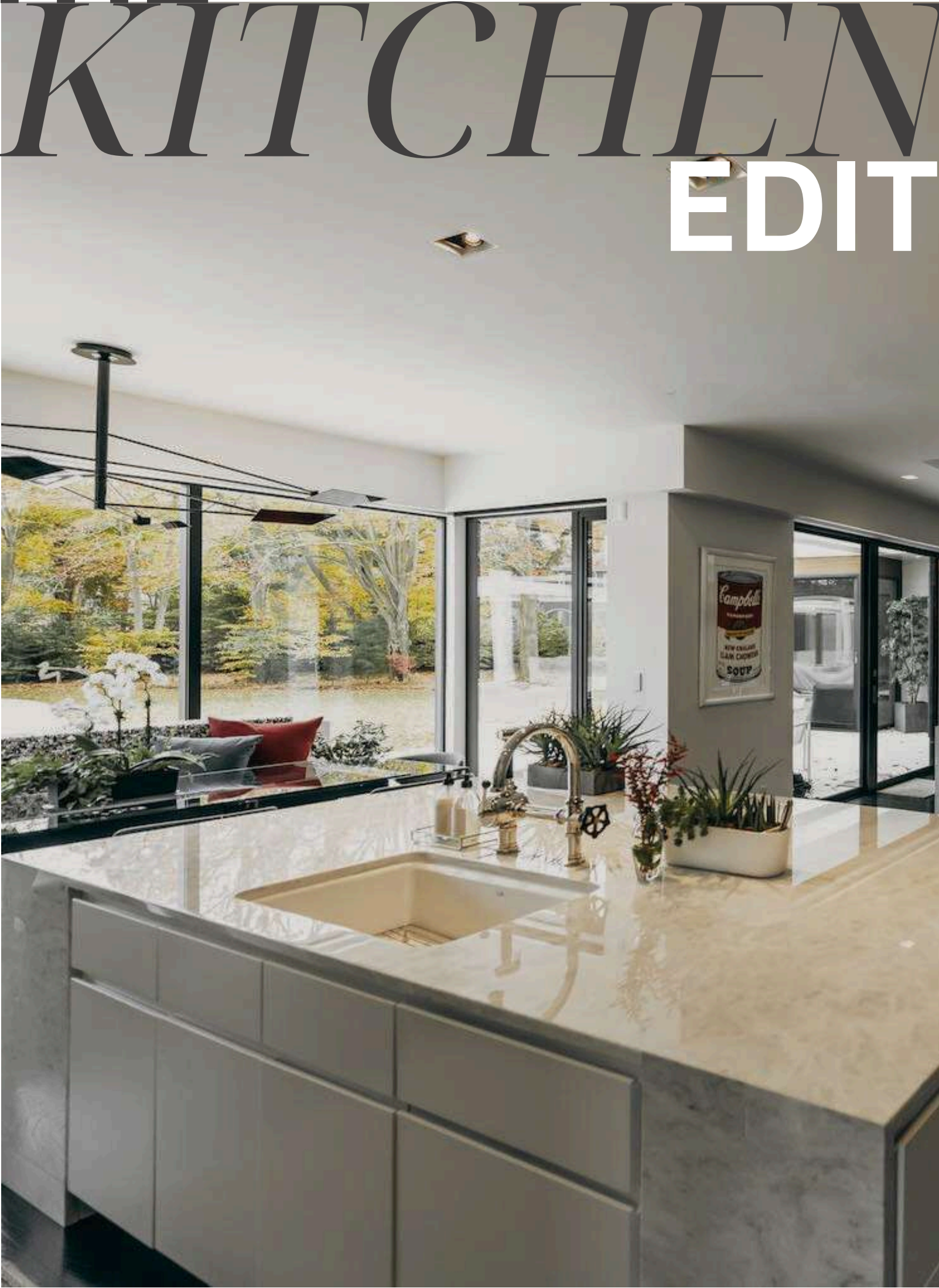

The kitchen stands as a luminous centerpiece, defined by pristine white marble countertops with subtle veining that adds organic movement to the minimalist space. Sleek grey lacquer cabinetry provides clean lines and reflective surfaces that amplify natural light. The island features a waterfall edge detail, emphasizing geometric precision. Stainless steel appliances and fixtures introduce industrial sophistication while maintaining the monochromatic palette. Full-height glass walls transform the surrounding landscape into living wallpaper, infusing the kitchen with natural color. Recessed lighting creates even illumination without visual distraction. The space balances utilitarian function with gallery-like restraint—a culinary workspace that doubles as a showcase for modernist design principles.

*A clean kitchen stripped to elegant essentials and light.*

ÉPURE















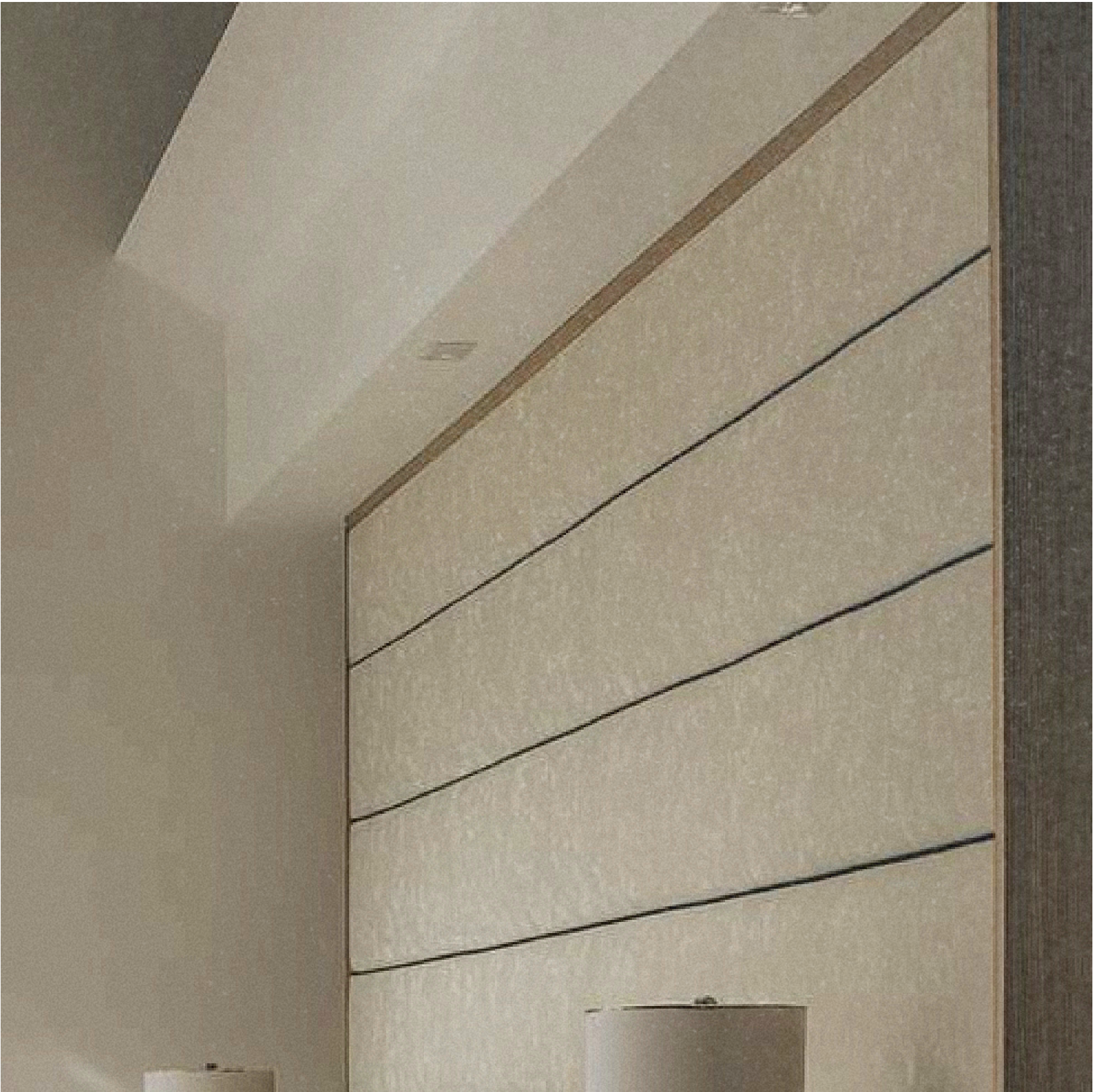

















*Inside* | EDITION #115









*Inside* | EDITION #115





*Inside* | EDITION #115





*Inside* | EDITION #115



*Inside*

# CATALOGUE

---

SHOP/BE INSPIRED/EDITION 115





LIVING STYLE

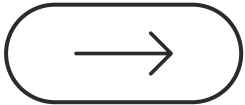

BERND SOFA

The Bernd Sofa features an ergonomic curved design, plush upholstery, and gently swooping backrest

EICHHOLTZ

Infinity Sculpture by renowned Dutch artist Frank Boogaard



OVNI UP TABLE

The unique cone shape of the OVNI cocktail tables appear as if the centre is being pulled downwards, and the thin concentric stripes create movement.

ROCHE BOBOIS

LIVING





LOUNGE STYLE

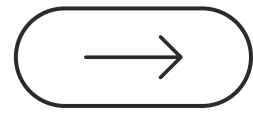

## AVIATOR LEATHER SOFA 88

Aviator is inspired by classic 1970s European designs for a look that's lived-in and relaxed

CB2



Silver fabric cushion by  
Lepang™



## VINTAGE TABLE

Post modern aluminium square coffee table with wooden under-frame

BAXTER ITALY

LOUNGE





BAR STYLE

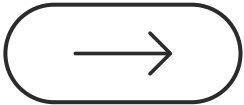

HIGH WOVEN BACK STOOL

A seamless, solid steel or stainless steel frame supports a hand-woven English Bridle leather seat.

MARK ALBRECHT STUDIO

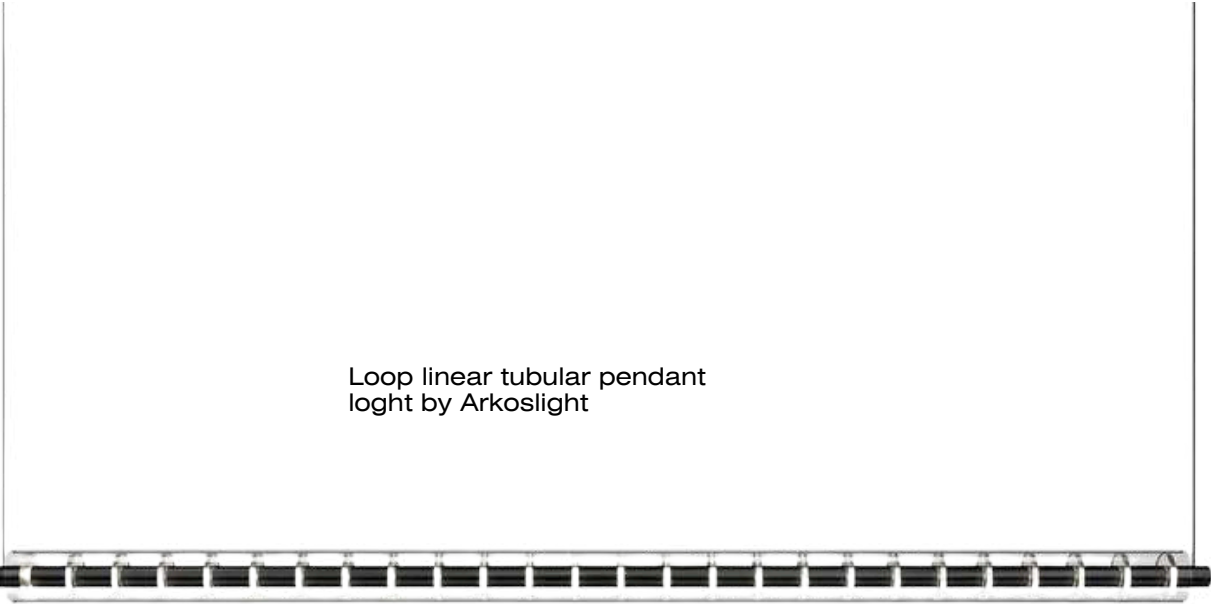

Loop linear tubular pendant  
loght by Arkoslight

BAR



MIRINA TABLE

Calacatta marble high table  
for kitchen and casual dining  
and bar areas

GILLIAN SEGAL



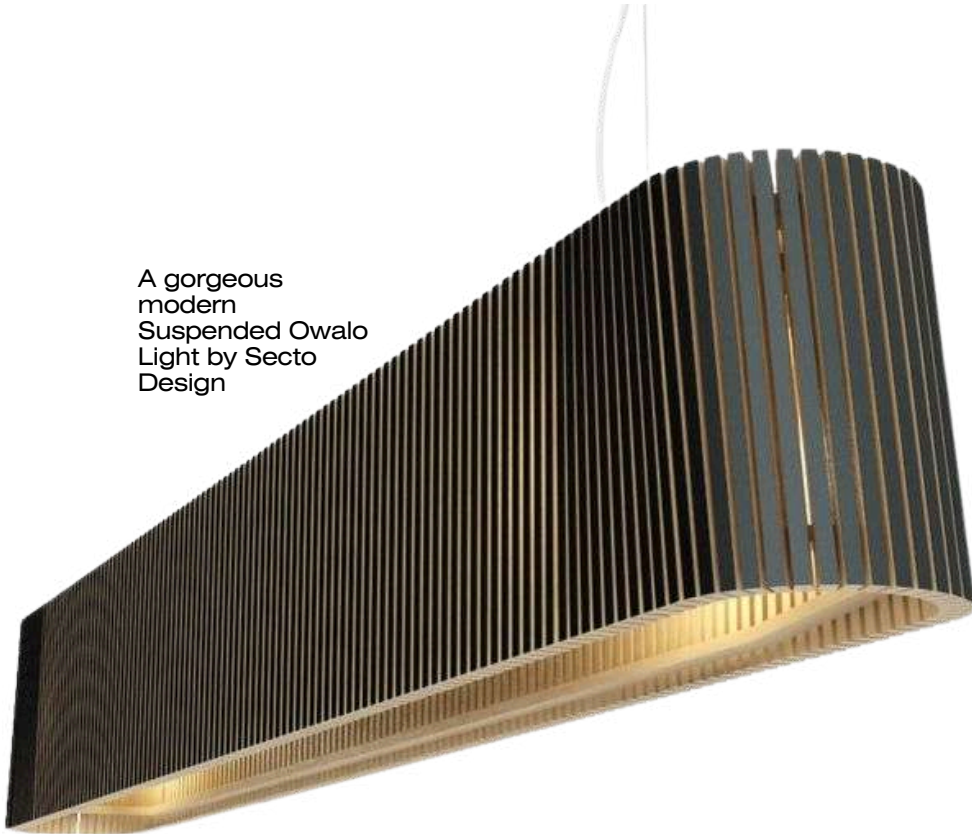

A gorgeous modern  
Suspended Owalo  
Light by Secto  
Design



DINING STYLE

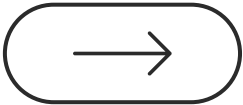

HAMILTON DINING TABLE

A Mid-Century modern elegant table with finishes from Sycamore Black wood to dark-tinted oak

1ST DIBS

DINING

MANILLE CHAIR

Modern chair with sleek frame and flared armrests

GINO COROLLO





KITCHEN STYLE

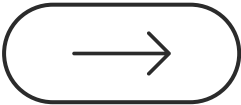

MESA HOOD

Stainless steel Wall Mount range hood with convertible venting function

ZEPHYR



Vintage style polished nickel faucet by AquaNuTech



CAFÉ™ STOVE

36" Smart Dual-Fuel Commercial-Style Range with 6 Burners

CAFÉ™ APPLIANCES

KITCHEN





BEDROOM STYLE

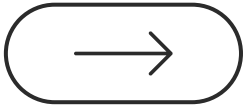

LANA BED

The Round Off collection is a showcase of organic oak, with the beautiful pale tones of the grain matched to a simple, comforting design.

MOBILIA

BEDROOM



Vintage style Glass Table Lamp with wood stand and silk shade by Lamparas De Mesa



MILAN NIGHTSTAND

Beige shagreen and brass drawer nightstand framed in walnut finished hardwood

NADER COLLECTION





BATHROOM STYLE

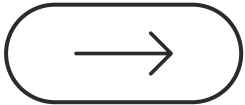

WS BATH

Free Standing Tempered  
Crystal Glass Bathtub with  
With pillows and elbow rests

WS BATH COLLECTIONS



OMAHA solid surface  
stool by Noveaqu



RIVA VANITY

walnut framed modern vanity  
with honed beige Marfil  
marble top

MIRANO BATH & SPA

BATHROOM





# MONOLISSE

*A single sculptural gesture that changes the entire room.*

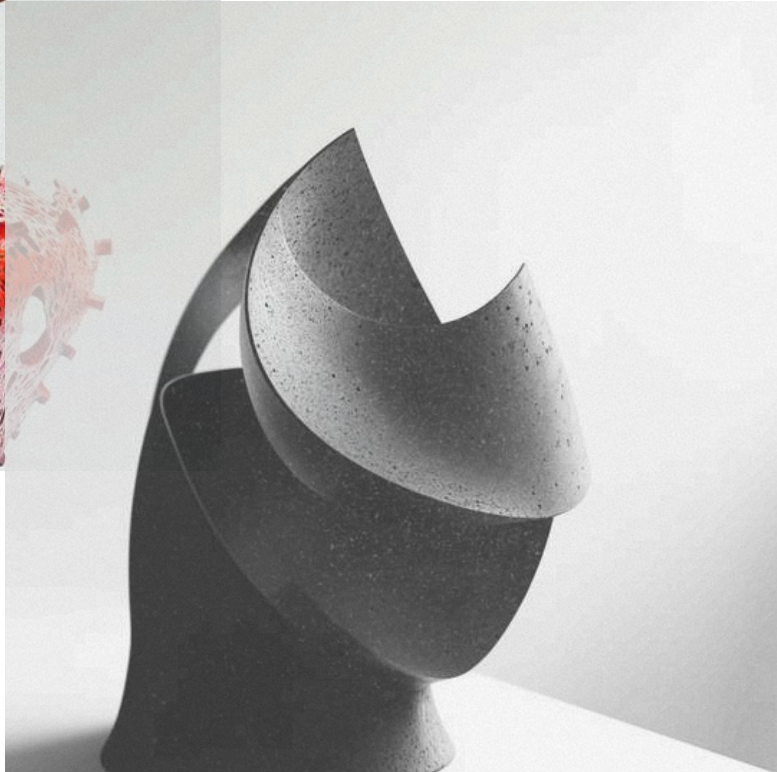

In the Old Westbury Residence, sculpture becomes soul. Each piece is a conversation—Crimson Bloom by Eliane Marette stirs motion through its molten red form, while Whisper Form by Hiroshi Watanabe offers meditative calm in smooth alabaster. Fragment Noir by Luca DeMare clings to the wall like frozen movement, and Echo Void by Adah Kim brings drama in charcoal resin. These curated works elevate the home beyond architecture, offering artistic punctuation and emotional texture. Sculpture adds value—not just monetary, but expressive—infusing interiors with individuality, story, and form. Art here isn't decoration; it's presence, commanding space with silence and shape.



/INSIDE MODE



# THE OUTDOOR EDIT

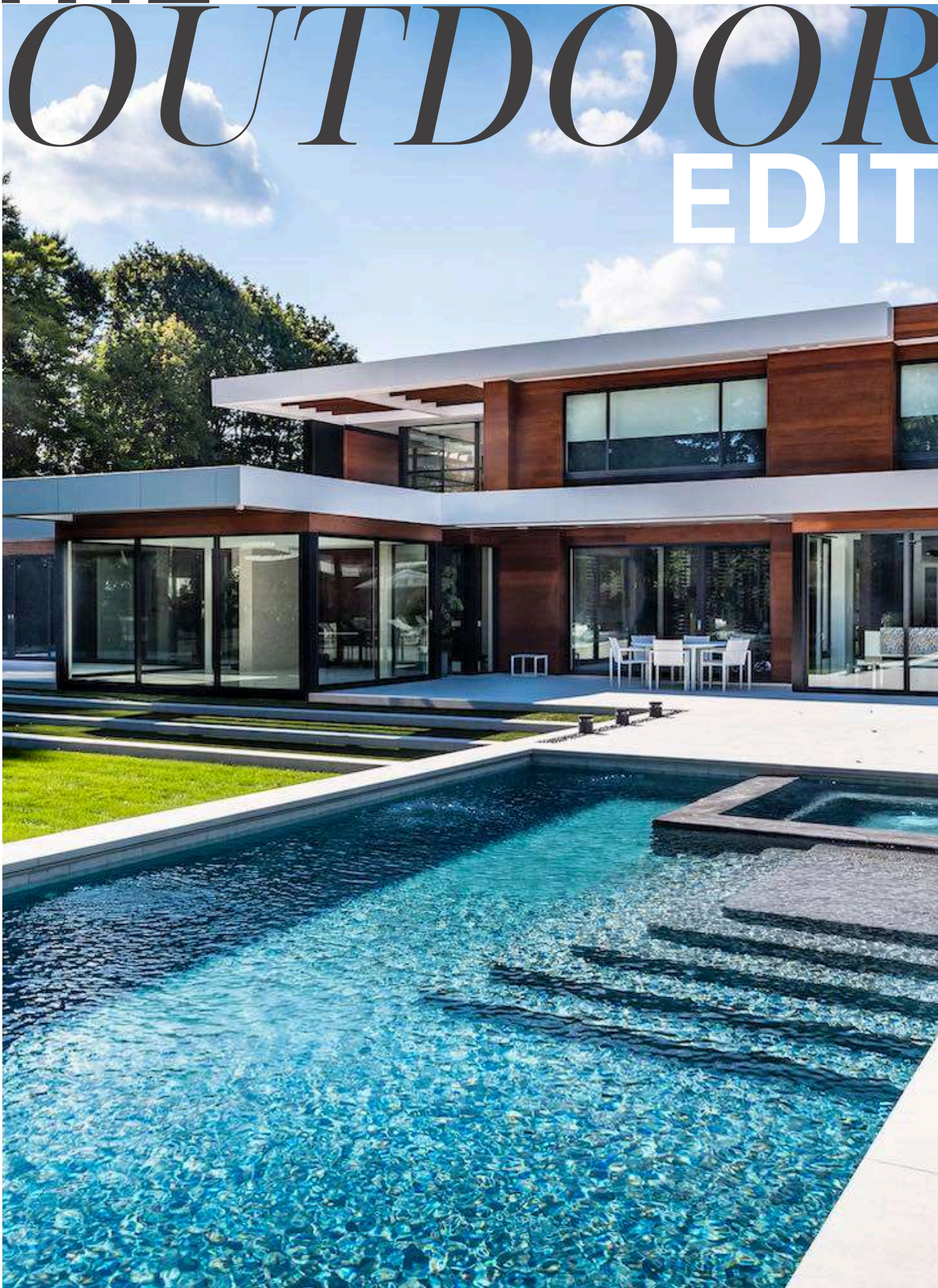

The exterior spaces continue the home's architectural language through geometric precision and material harmony. Large concrete pavers create a rhythmic grid pattern, softened by grass interstices that introduce organic texture. The infinity lap pool extends the home's linear quality, its reflective surface mirroring sky and architecture. Rich mahogany reappears in the cabana's slatted screens, providing continuity with the main structure while creating dappled light patterns. Strategic plantings of low-maintenance greenery frame architectural elements without overwhelming them. Outdoor living areas function as exterior rooms, with clean-lined furniture echoing the home's minimal aesthetic. The landscape design emphasizes horizontal planes that lead the eye outward toward mature trees that provide natural enclosure and privacy.

*Greenscape meets design in fresh, clean outdoor composition.*

VERDÉA

























OUTDOOR STYLE

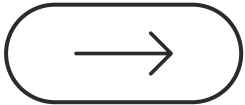

1966 DINING CHAIR

Designer outdoor chair in metal and mesh for Knoll

RICARD SCHULTZ

White ceramic planter  
by Luno House



OUTDOOR

FRANK TABLE

White hardwood table in a modern minimal style

CB2

























*Inside* | EDITION #115



## SETTING THE STANDARD



Residential | Hospitality |  
Commercial

[www.lepangluxury.com](http://www.lepangluxury.com)

LEPANG  
LUXURY INTERIORS



T H E  
D R E A M  
S O F A

---

cocoon



*LUXE  
LIVING*

@ L E P A N G L U X U R Y I N T E R I O R S

---



INSIDEINTERIORSMAGAZINE.COM

WE ARE  
REDEFINING  
LUXURY LIVING  
*through interiors and  
architecture*

Design is a canvas, and the brush is in our hands. Every choice, every stroke shapes the direction, breathing life into spaces and products that tell a story. This is what inspires me—to create with intention, to craft environments that feel alive. For design communities worldwide, this is more than work; it's our shared narrative.

LEPANG FERGUSON







REDEFINING LUXURY LIVING

[WWW.INSIDEINTERIORMAGAZINE.COM](http://WWW.INSIDEINTERIORMAGAZINE.COM)